

# Columbia Avenue/Main Street

Complete Street Project

April 27, 2021



Haytham Hassan, P.E.  
Department of Public Works  
City of Dallas

Barry Evans, P.E.  
Huitt-Zollars, Inc.



**Notice**  
**Audio and Video**  
**Recording in Progress**

**Please mute your microphone**



# Introductions

## Council Members:

- District 2: Mayor Pro Tem Adam Medrano
- District 14: Council Member David Blewett
  
- City of Dallas Staff



# Purpose of Meeting

- Project Purpose
- Project Overview
- Complete Street Vision & Design Elements
- Project Timeline
- Community Priorities (Prior Public Meetings Summary)
- Current Design Plans incorporate community and stakeholder input to the extent practicable
- Instructions for Community Feedback



# Project Purpose

Initiated by the community with the goals to:

- Improve walkability and bikeability
- Improve safety for all transportation modes
- Calm traffic
- Connect the neighborhoods



**Main at Washington**



**Columbia at Orient**



# Project Overview

- Council District 2 and 14
- Limits: Columbia Avenue/Main Street from South Beacon Street to Deep Ellum
  - Includes bike lanes on Peak St. and Elm St.
- 2017 Capital Bond funding amount: \$4,250,000
- Proposed Project Scope: Complete Street improvements including bike lanes



# Project Overview – Location Map

## Columbia/Main from South Beacon Street to Deep Ellum

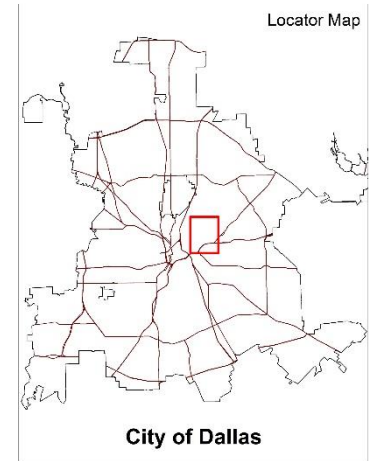

# Project Overview - City of Dallas Complete Streets



Sources: Esri, HERE, DeLorme, USGS, Intermap, INCREMENT P, NRCan, Esri Japan, METI, Esri China (Hong Kong), Esri Korea, Esri (Thailand), Mapbox, Swatch, © OpenStreetMap contributors, and the GIS User Community





# Complete Streets Vision

The City of Dallas adopted a Complete Streets Manual January 27, 2016, directing all roadway projects to design and build streets that are safe and comfortable for everyone: all ages and abilities; motorists and bicyclists; pedestrians and wheelchair users; bus and train riders alike.

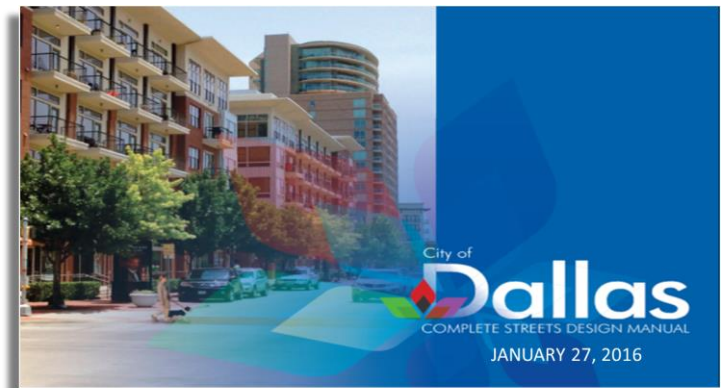

# Complete Street Design Elements

- Enhanced sidewalks
- Streetscaping/Landscaping
- Improved street crossings
- Protected bike lanes
- Bus stop improvements
- Stormwater improvements
- On-street parking

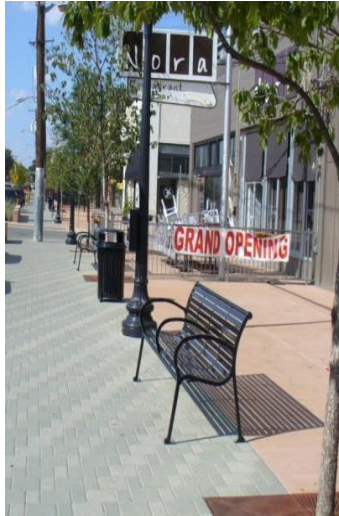

# Project Timeline

## What we have accomplished to date:

- ❖ Community Engagement
  - 1<sup>st</sup> Public Meeting (Workshop) on August 7, 2018
  - 2<sup>nd</sup> Public Meeting (Workshop) on August 14, 2018
  - 3<sup>rd</sup> Public Meeting on October 23, 2018
  - 4<sup>th</sup> Public Meeting on August 8, 2019
  - 5<sup>th</sup> Public Meeting on October 16, 2019
  - 6<sup>th</sup> Elm St. Bike Lanes, November 20, 2020
  - 7<sup>th</sup> Elm St. Bike Lanes, December 22, 2020
  - 8<sup>th</sup> Public Meeting on April 27, 2021
  
- ❖ Thoroughfare Plan Amendment Approved January 23, 2019

## What we have left to accomplish, Estimated Schedule:

- Design: Summer 2021
- Construction Award: Fall 2021
- Construction: October 2021 to December 2022



# Community Priorities for Main Street



- Bike racks
- Bus stops
- Head-in parking
- Intersection safety
- Landscaping
- Left turn signals
- Parallel parking
- Pedestrian lights
- Pedestrian crossings
- Protected bike lane
- Santa Fe Trail connections
- Sidewalks
- Street furniture
- Street lights
- Traffic calming
- Traffic signal at Washington



# Thoroughfare Plan - Main Street between Exposition Street and Peak Street

## Old Designation

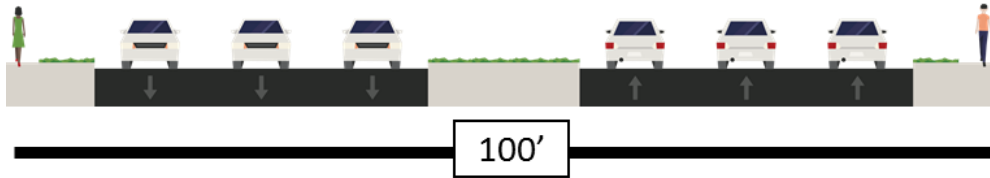

- Functional and dimensional classification changed from six-lane divided roadway (M-6-D) to a special four lane undivided roadway (SPCL 4U)

## Existing Operations

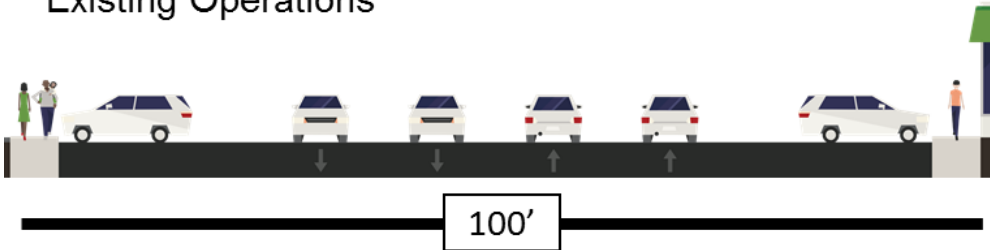

- Parking becomes parallel
- No bike lanes
- Wider sidewalk

## New/Current Designation After January 23, 2019

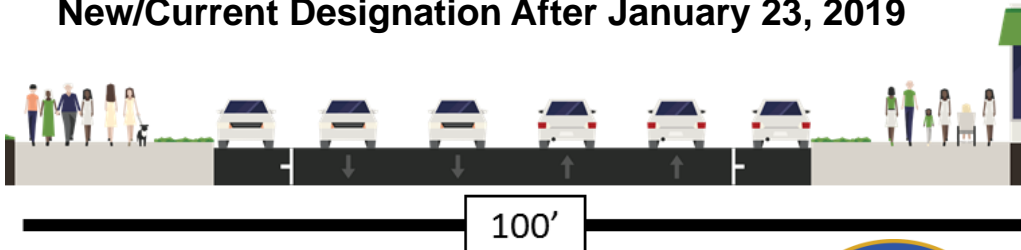

# Main Street from DART track to Peak Street – Selected “Option 2”

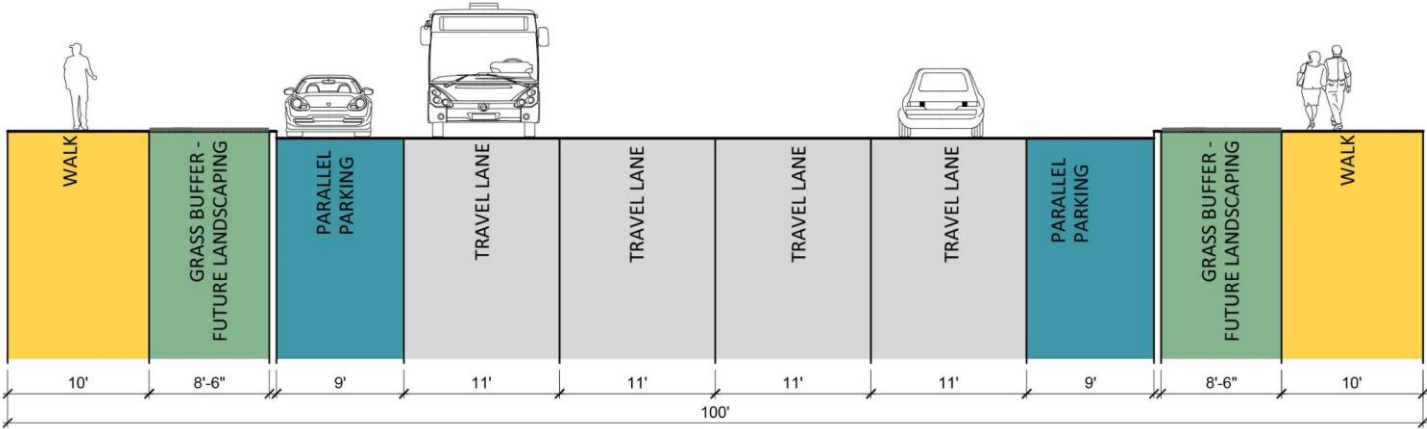

Total Existing Parking	Total Design Parking
79	70



# Main Street from DART track to Peak Street – Selected “Option 2”

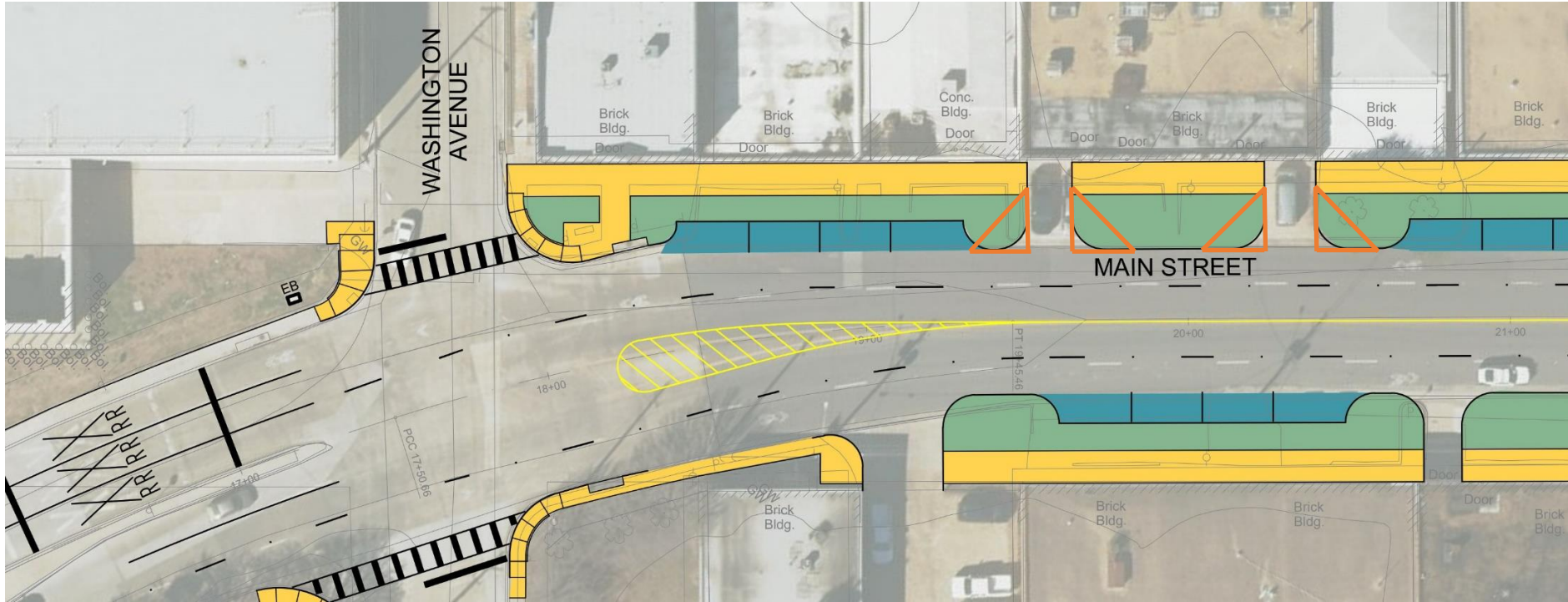
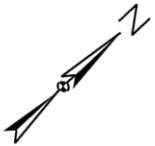

Existing Parking	Design Parking
46	13



# Main Street from DART track to Peak Street – Selected “Option 2”

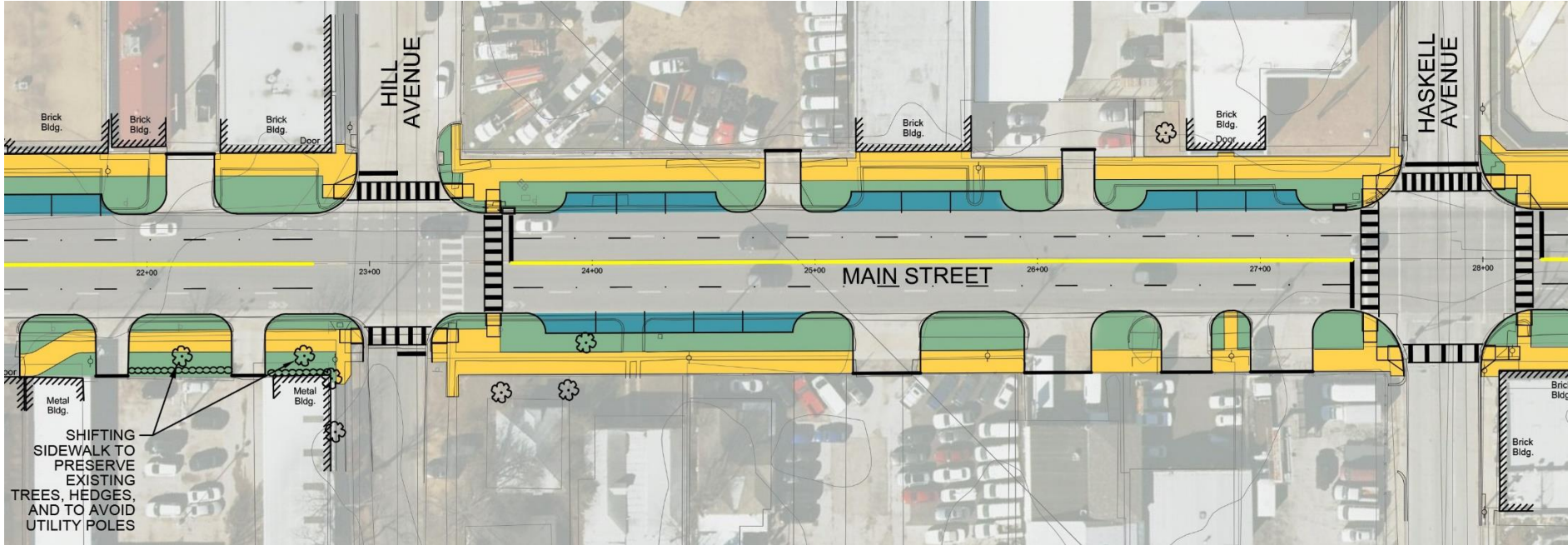
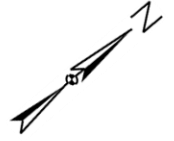

Existing Parking	Design Parking
17	14





# Main Street from DART track to Peak Street – Selected “Option 2”

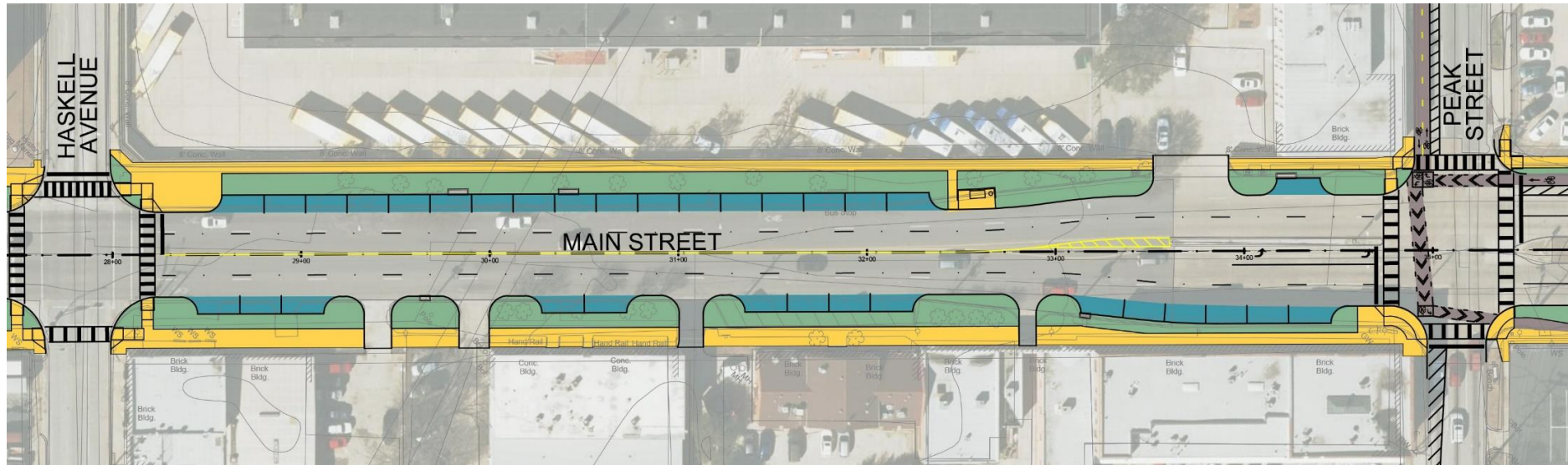
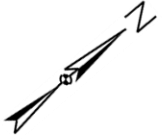

Existing Parking	Design Parking
16	33



# Project Overview – Location Map

## Columbia/Main from South Beacon Street to Deep Ellum

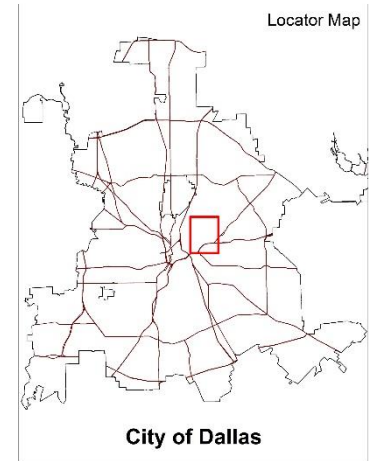

# Elm Street Bike Lane Overview At Haskell

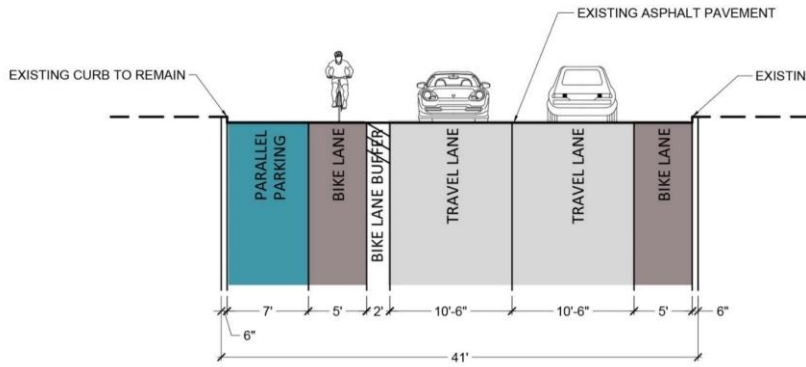

Haskell to Washington

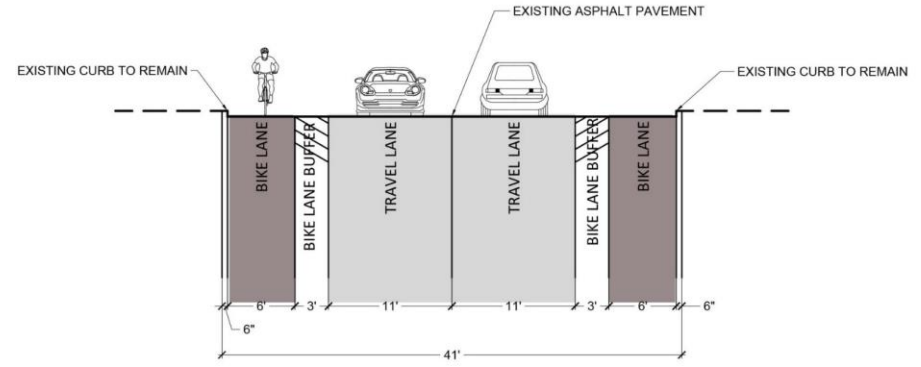

Peak to Haskell

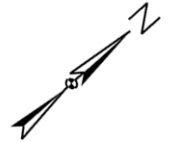
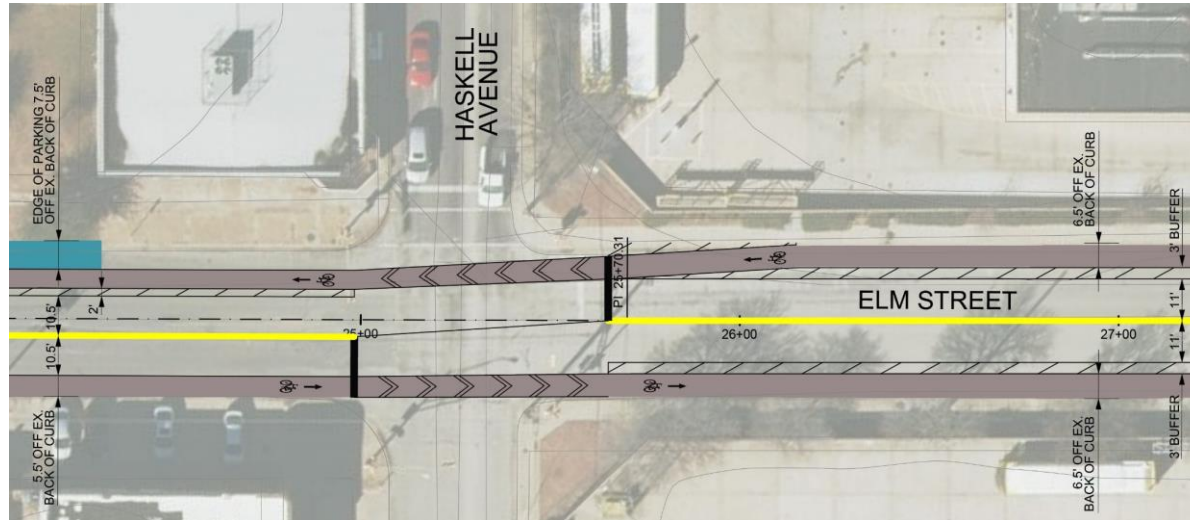

# Elm Street Bike Lane Overview At Washington

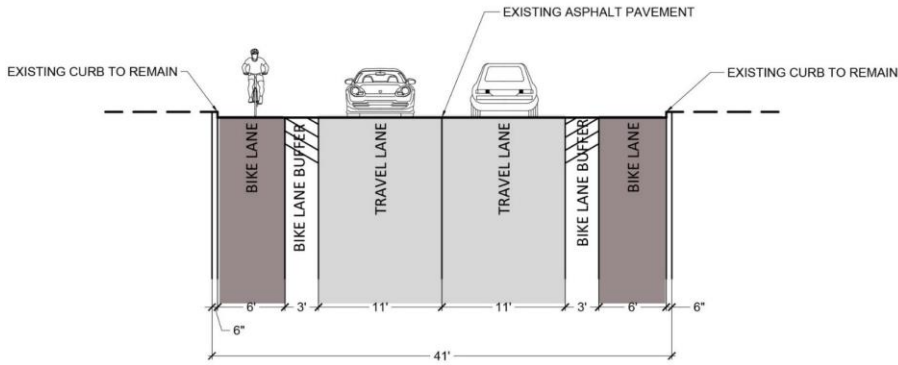

Washington to Santa Fe Trail

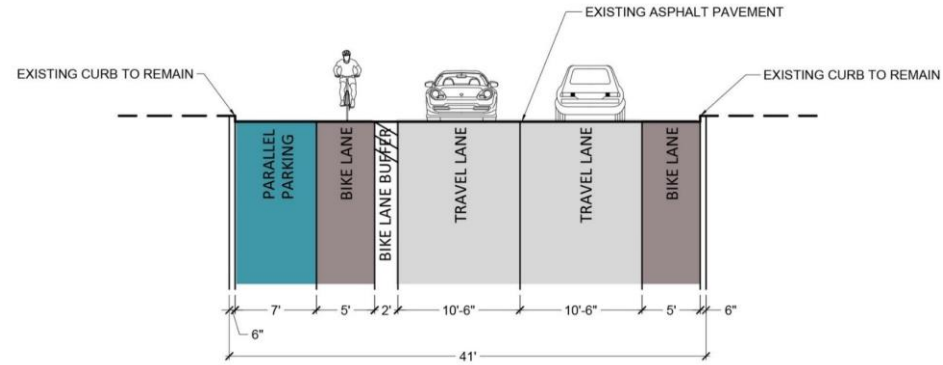

Haskell to Washington

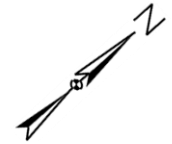
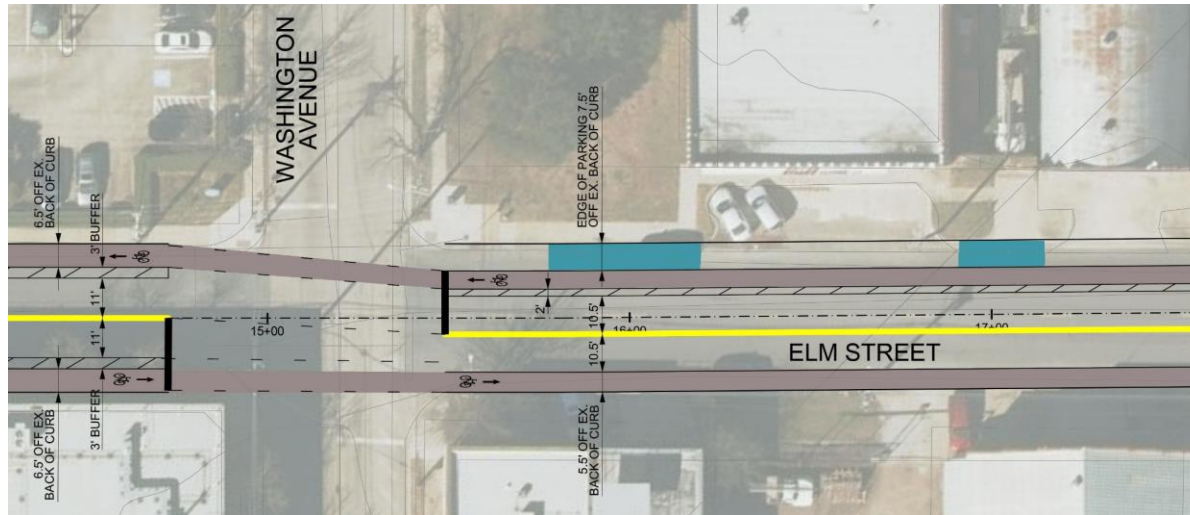

# Main Street between Peak and Carroll

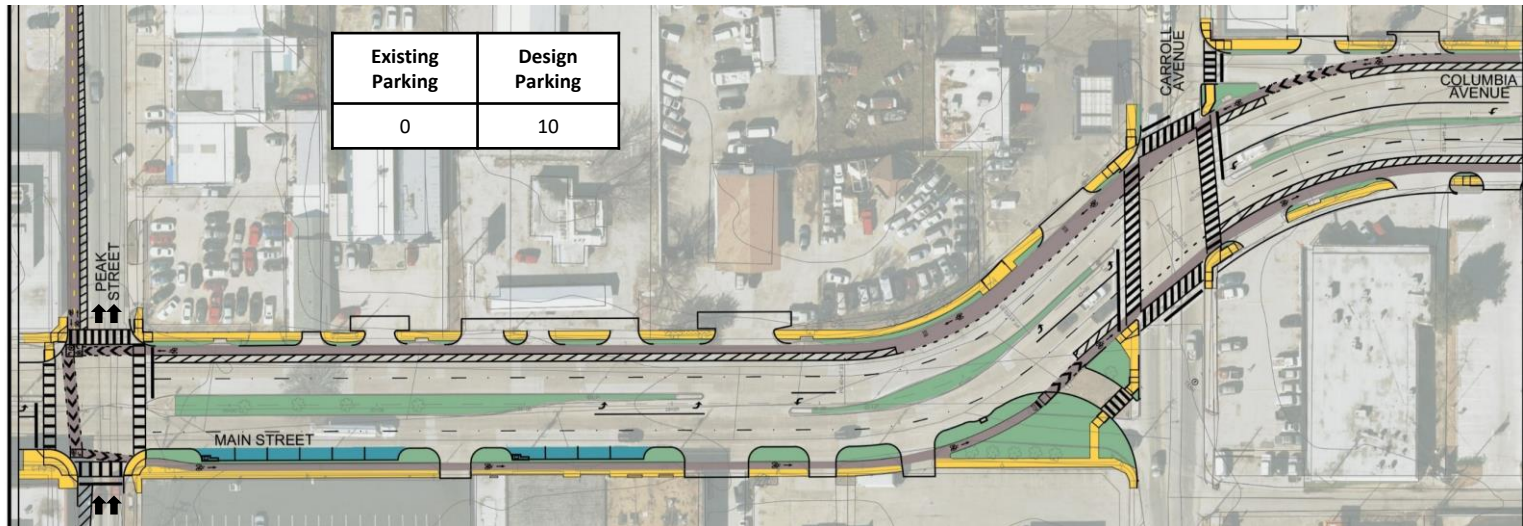
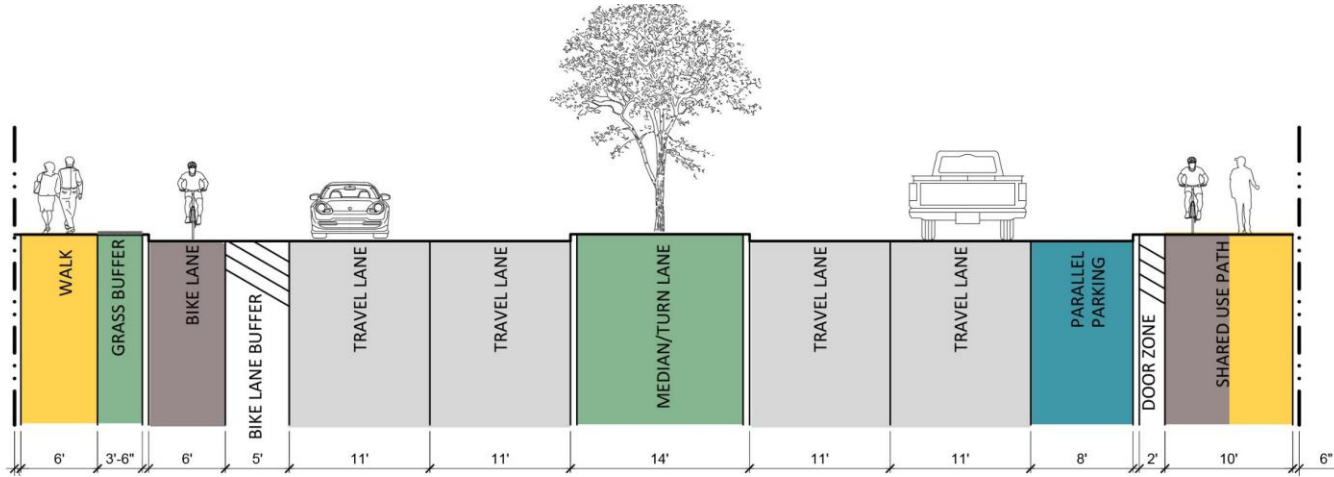

# Community Priorities for Columbia Avenue



- Bike racks
- Bus stops
- Intersection safety
- Landscaping
- Mid-block crossings
- Pedestrian crosswalks
- Pedestrian lights
- Pedestrian signals
- Protected bike lanes
- On-street parking
- Sidewalks
- Traffic calming
- Turn signal at Carroll



# Thoroughfare Plan - Main Street and Columbia Avenue between Peak Street to Beacon Street

## Old Designation

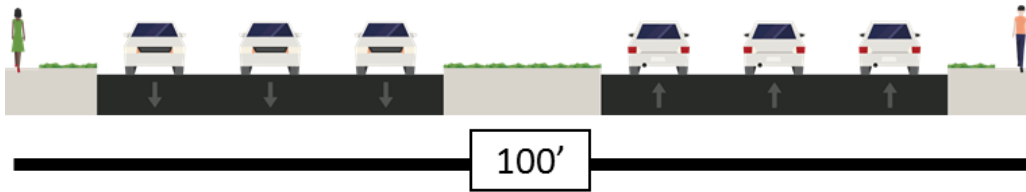

## Existing Operations

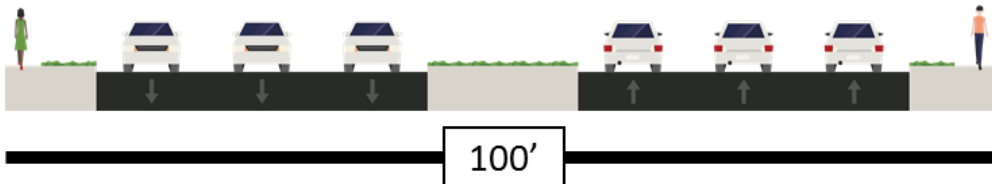

## New/Current Designation After January 23, 2019

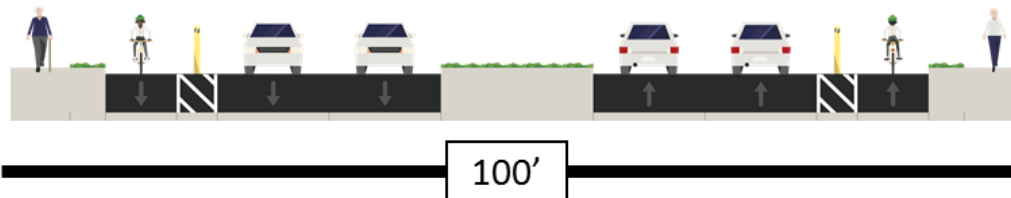

- Functional and dimensional classification changed from six-lane divided roadway (M-6-D) to a special four lane divided roadway (SPCL 4D) with bicycle facilities
- Protected bike lanes on street level
- Wider sidewalk



# Columbia Avenue Mid-Block

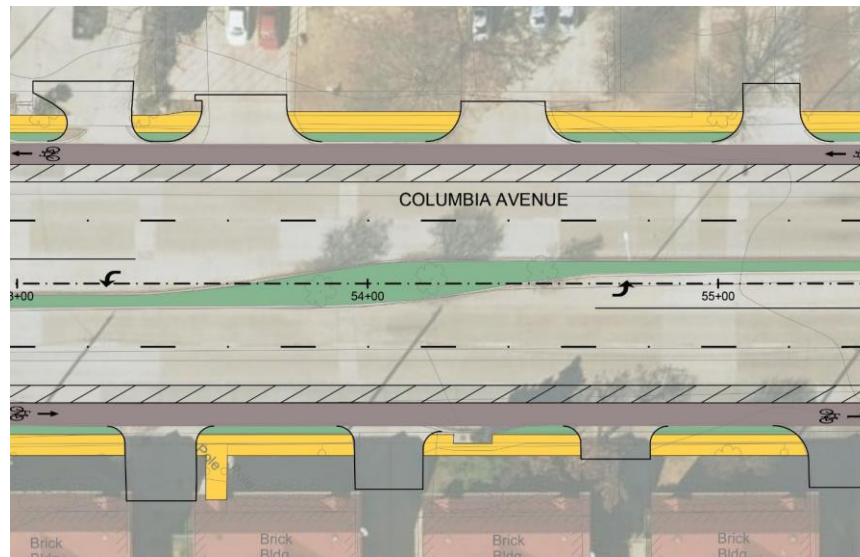
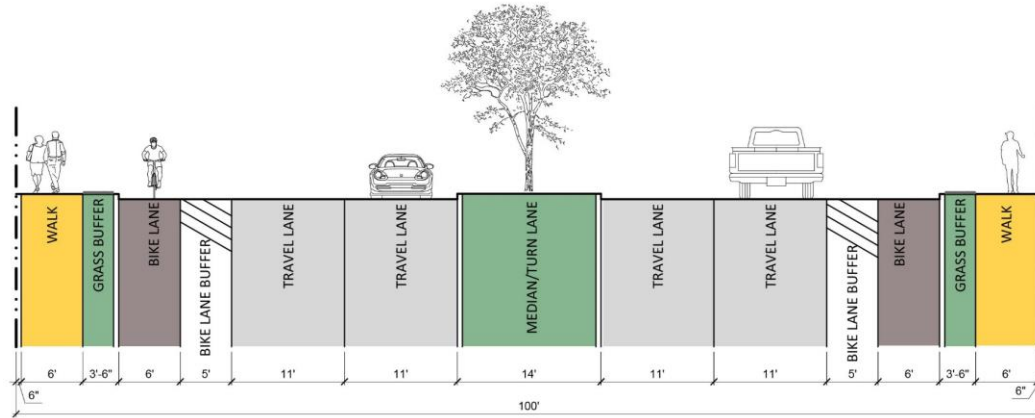



# Columbia Avenue At Intersections

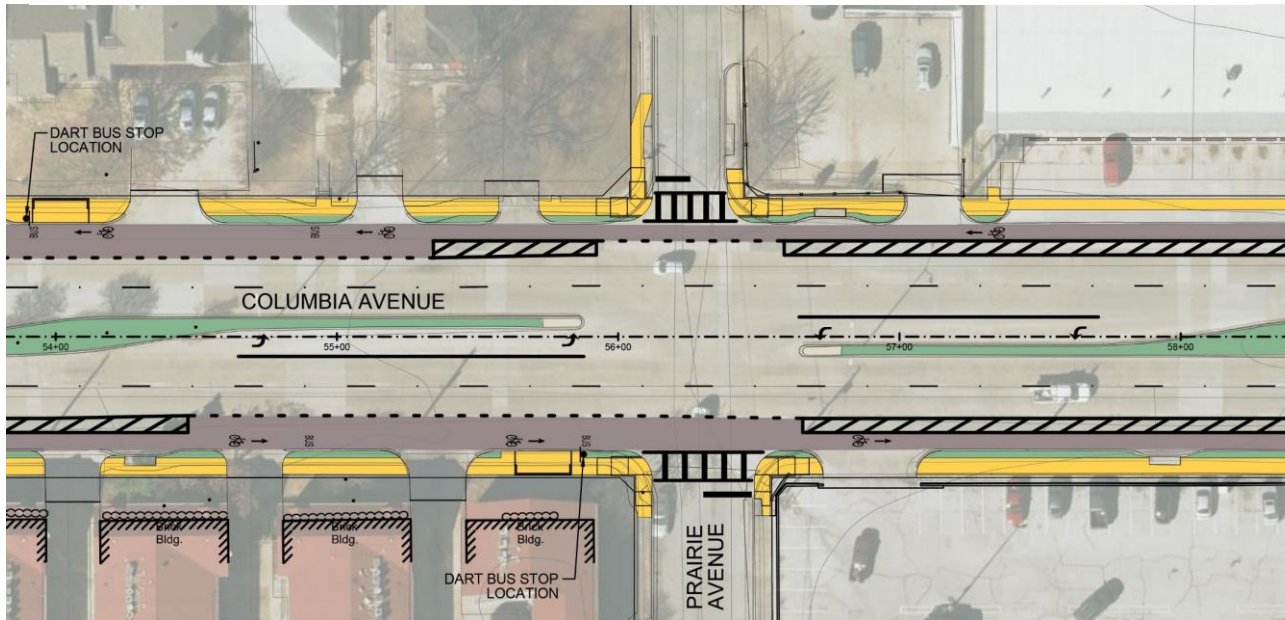
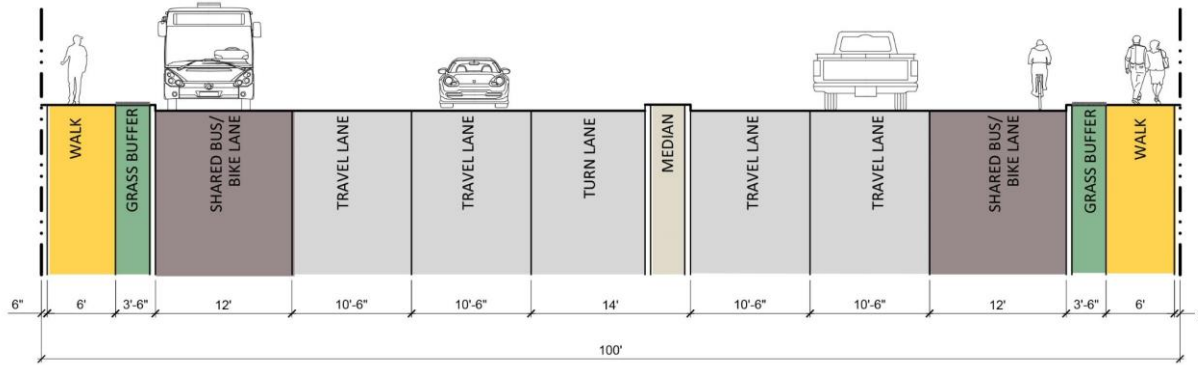

# Columbia Avenue – West of Fitzhugh Ave.

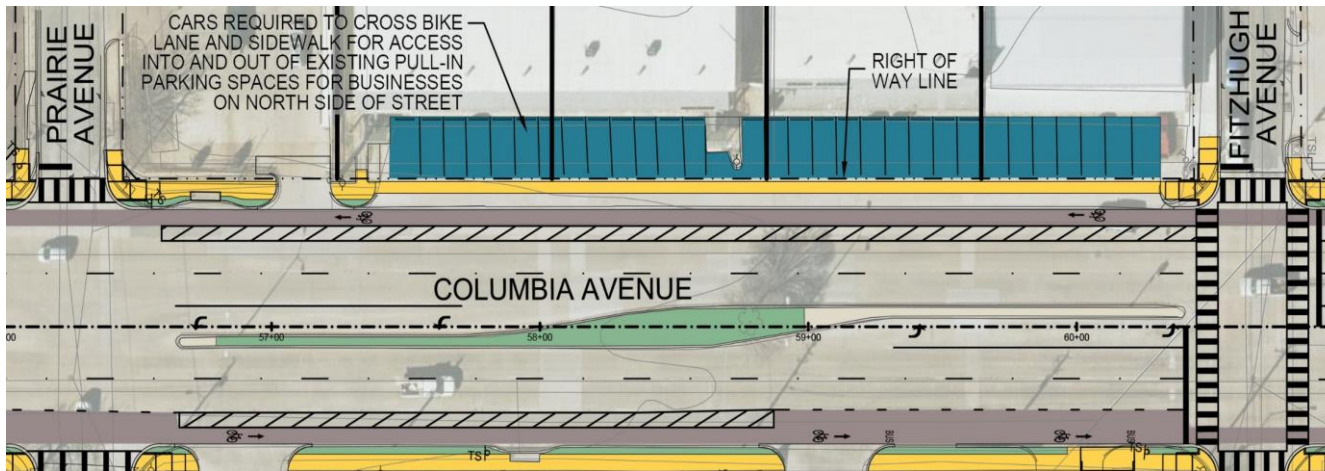
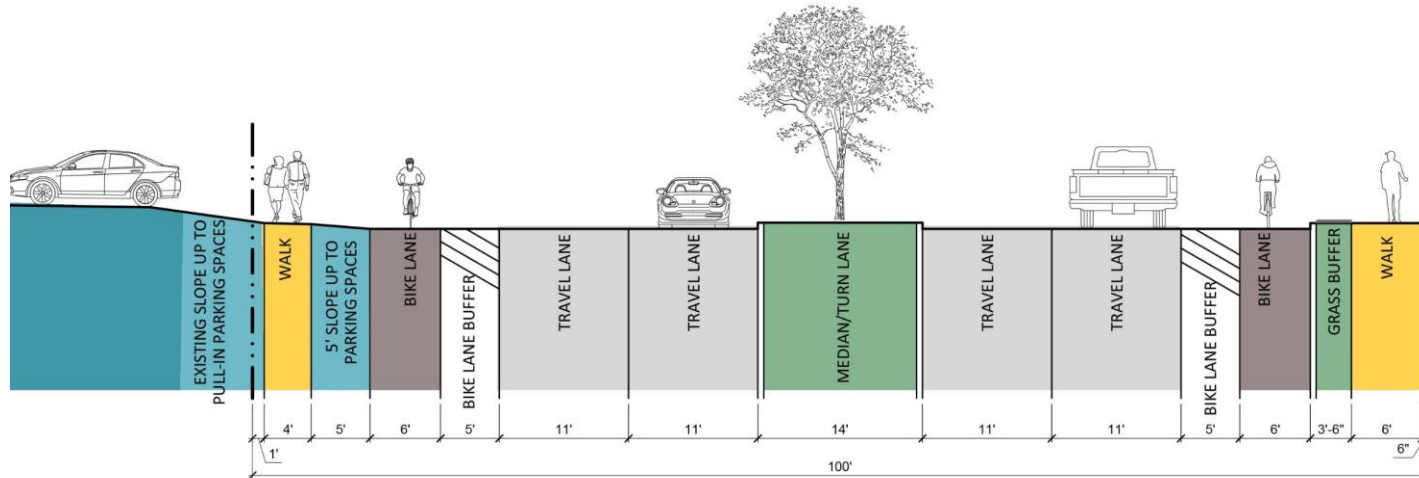

# Columbia Avenue – West of Fitzhugh Alternative

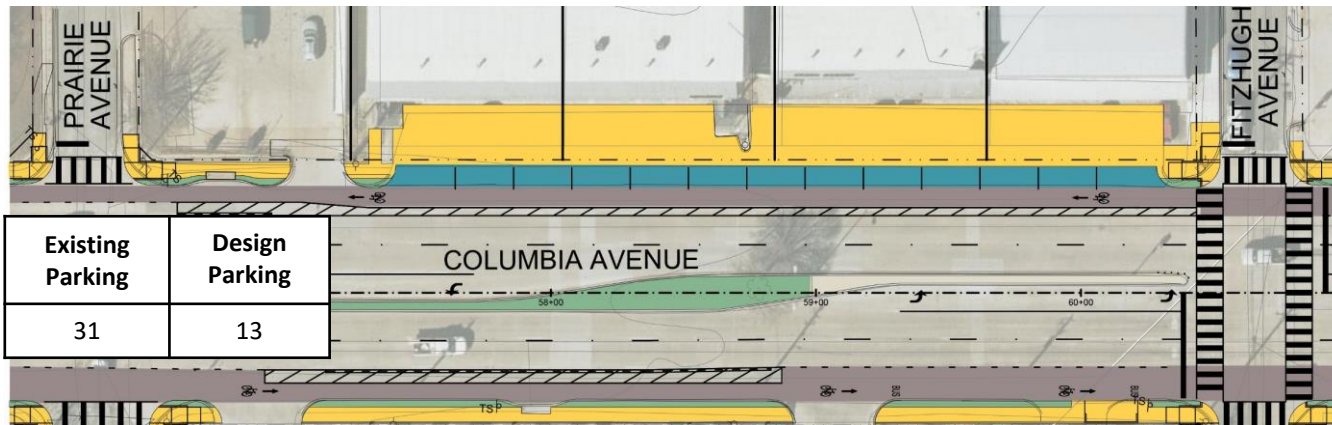
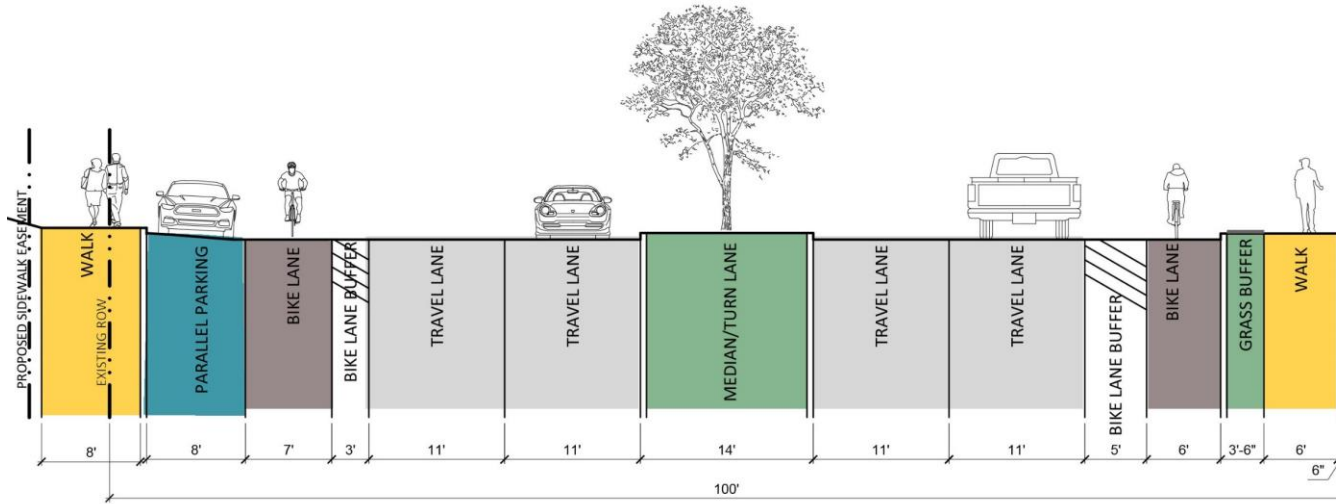

# Community Feedback

Written Comments about the project will be accepted until **Friday, May 7, 2021**

- Please provide comments online at:

**<https://bit.ly/CMComment0421>**



# City of Dallas Department of Public Works Staff Contact

Ryan Wagoner, PR Coordinator  
[tony.payberah@dallascityhall.com](mailto:tony.payberah@dallascityhall.com)  
(214) 948-4576

Tony Payberah, P.E., Senior Project Manager  
[tony.payberah@dallascityhall.com](mailto:tony.payberah@dallascityhall.com)  
(214) 948-5363

Tawnya Lane, P.E., Assistant City Engineer  
[tawnya.lane@dallascityhall.com](mailto:tawnya.lane@dallascityhall.com)  
(214) 948-4685

Christina Turner Noteware, P.E., City Engineer  
[christina.turner@dallascityhall.com](mailto:christina.turner@dallascityhall.com)  
(214) 948-4295

